

---

# Peace of Mind

AND IMPROVED OUTCOMES.



Our cutting edge technology delivers a system that enables you to benefit from Biodata monitoring and digestible data analysis, dispensed to you via our Embrace and Liberate tablet devices. Thereby, allowing you to be fully informed in making prompt intervention decisions with regard to any health abnormalities.

**CONTACT US TODAY!**

---

📍 95 West Main St. Suite 11, Chester NJ  
☎ + 1 (908) 955 7734 ✉ info@tls.global

---

 **www.tls.global**

Non-Intrusive, image and hands free, privacy assured sensors.

Whether you want to monitor a seniors health at home or have added comfort and security of constant attention in a residential format, our system generates alerts of discrepancies associated with the monitoring of vital signs: Heart Rate (Interval and Variability), Respiration (Rate and Depth), Inhale-Exhale Ratio, Continuous and Spot Check Modes.



An advancement in medical observation that keeps individuals educated, notified and fully regulated when it comes to personal health care issues.

---

Introducing

# Respiratory Module

Powered by  neteera



---

# TRANQUILITY

## Lifestyle Solutions



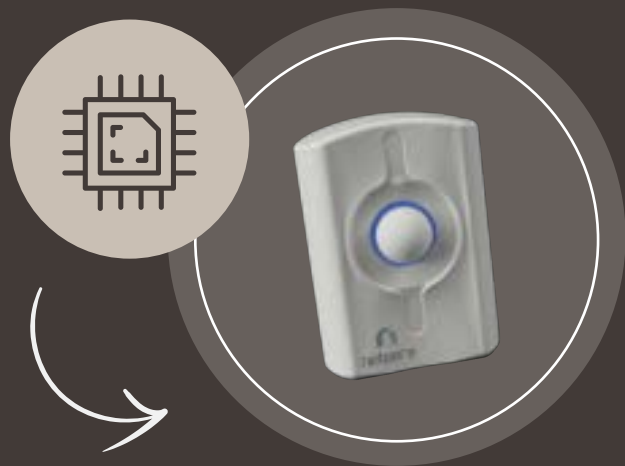

---

A serviced technology that provides quantifiable health check monitoring of prominent vital signs, such as HEART RATES and RESPIRATORY RATES.

Cutting edge technology that combines extraordinary sensing competence with an extensive data collection capacity, via a system that is free from CAMERAS, WEARABLES, and PENDANTS!



## SENSING VITAL SIGNS THROUGH CLOTHING

-  Heart Rate (Pulse)
-  Respiration Rate
-  Heart Rate Variability
-  Respiration Amplitude

A completely personalized healthcare management system.

## HOW WE DO IT?

Our sensor operates at very high frequency (116 GHz123- GHz) and senses micro-skin displacements through clothing and from a distance. These are then interpreted into vital signs and other behavioral indicators by our algorithm and serve to assess the person's physiological status. It can be used while the senior is in a sitting, standing, or lying position.

Vital signs can be checked remotely, continuously, and most importantly, without physical contact – thus seamlessly and safely facilitating rapid and accurate detection of fluctuations in health condition in real-time.

Available through  
**Embrace and Liberate!**  
(Our B2B and B2C Solutions)

